

Data Sheet

LuxemBright® Channel Letter Illumination System

Product Description

The LuxemBright® LED channel letter illumination system is a low voltage, highly efficient alternative to traditional neon and fluorescent lighting. It offers easy installation, durability, and a long life span for all of your channel letter illumination needs. 10 LEDs per module design allows for extremely bright and homogenous lighting.

About CAO Group, Inc.

CAO Group, Inc. is an ISO 9001 certified company headquartered in the United States, with a TS 16949 certified manufacturing facility located in China. CAO Group was founded in 2000 by Dr. Densen Cao. CAO Group is committed to manufacturing high quality innovative products to our customers.

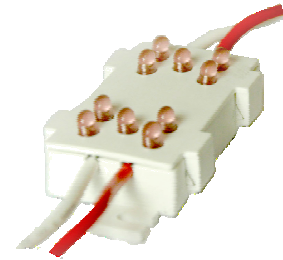

Applications:

- Front Lit and Halo Lit Signs
- Cabinet Light Boxes
- Architectural Lighting

Features:

- UL Recognized (#: E300609)
- Pixel Type Light Source
- Colors Available in White, Warm White, Red, Orange, Amber, Green and Blue
- Each Module is Potted for Water-Resistant
- Uniform Color and Coverage
- Optimum Heat Management
- Available in 2 or 3 Modules Per Foot
- Cut and Splice at any Point Between Modules
- Adhesive Pull Tab

Benefits:

- Energy Efficient
- Long Life
- Environmentally Friendly
- RoHS Compliant
- Non-Hazardous Waste
- Low Carbon Footprint



Mechanical Dimensions

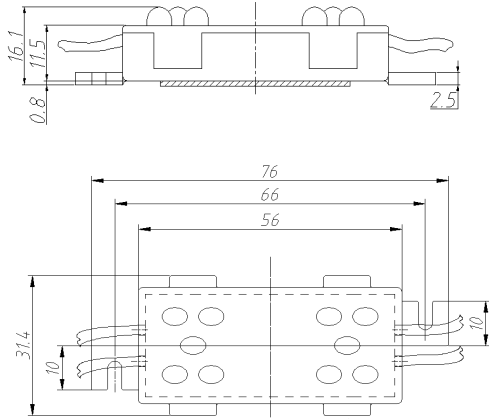

Notes:

- Connect red wire to DC positive and white wire to DC ground.
- All dimensions are in mm.
- Dimensions without tolerances are for reference only.
- Connection wires are 18 AWG.

Technical Specifications

Part #	Color	Light Output per Foot (Lumen)	Typical λ /CT	LED View Angle	Input Voltage (VDC)	Power Consumption per Module (W)	Modules Per Foot	Expected Life (Years)
770-W0013	White	96	9,000K	50/110°	12	0.8	3	4
770-W0014	Warm White	60	3,000K	50/110°	12	0.8	3	4
770-R0013	Red	48	625nm	50/110°	12	0.5	3	5
770-E0013	Orange	54	605nm	50/110°	12	0.5	3	5
770-Y0013	Yellow	96	590nm	50/110°	12	0.5	3	5
770-G0013	Green	90	522nm	50/110°	12	1.0	3	5
770-B0013	Blue	30	473nm	50/110°	12	1.0	3	4
772-W0013	White	72	9,000K	50/110°	12	0.8	2	4
772-R0013	Red	32	625nm	50/110°	12	0.5	2	5
772-E0013	Orange	36	605nm	50/110°	12	0.5	2	5
772-Y0013	Yellow	64	590nm	50/110°	12	0.5	2	5
772-G0013	Green	60	522nm	50/110°	12	1.0	2	5
772-B0013	Blue	20	473nm	50/110°	12	1.0	2	4



Power Supplies

Specifications

Prod #	Watt (W)	Input Voltage (VAC)	Max Input Current (A)	Output Voltage (VDC)	Max Output Current (A)
771-16212	60	90-264	1.5 A @ 100VAC	12	5.0
771-16312	60	100-277	1.5 A @ 90 VAC	12	5.0
771-14012	40	100-240, 277	0.5 A @ 115 VAC	12	3.3

Packaging

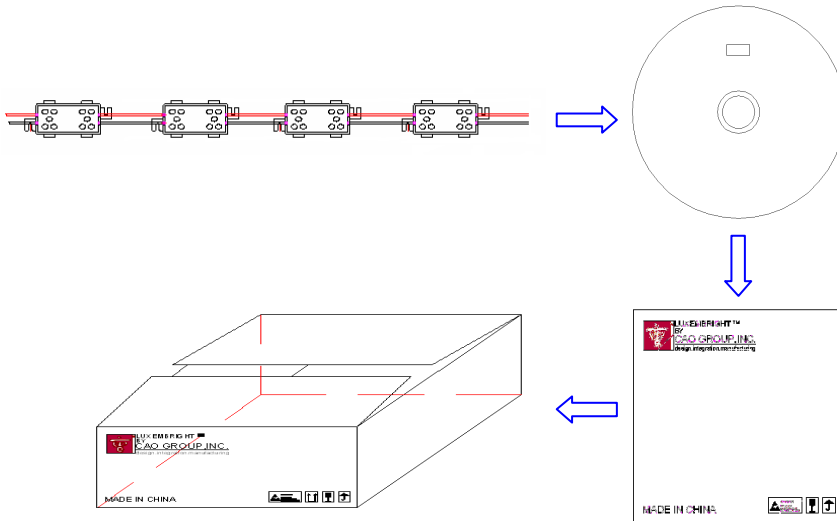

Notes:

LuxemBright® is packaged as 50 feet per reel. Each reel is packaged in an individual carton box.

Each outer carton box contains five inner carton boxes, totaling 250 feet per outer carton box.

www.caogroup.com

For product information and a complete list of sales representatives, please go to our website.

For technical assistance call:

US/Canada: +1 (877) 877-9778 or (801) 256-9282

Data subject to change.

Copyright reserved by CAO Group, Inc. No part of this datasheet may be reproduced in any form without the permission from the publisher.